



Bids & Awards Committee

BID BULLETIN No. 02

RE: Solar Power and Upgrading Electrical System 2nd Bidding PB 2026-IP-02

This Addendum No. 02 is issued to modify or amend items in the Bid Documents. This shall form an integral part of the Bid Documents.

1. ANNEX B (Plans - Figure 2: Product Dimensions)

FROM:

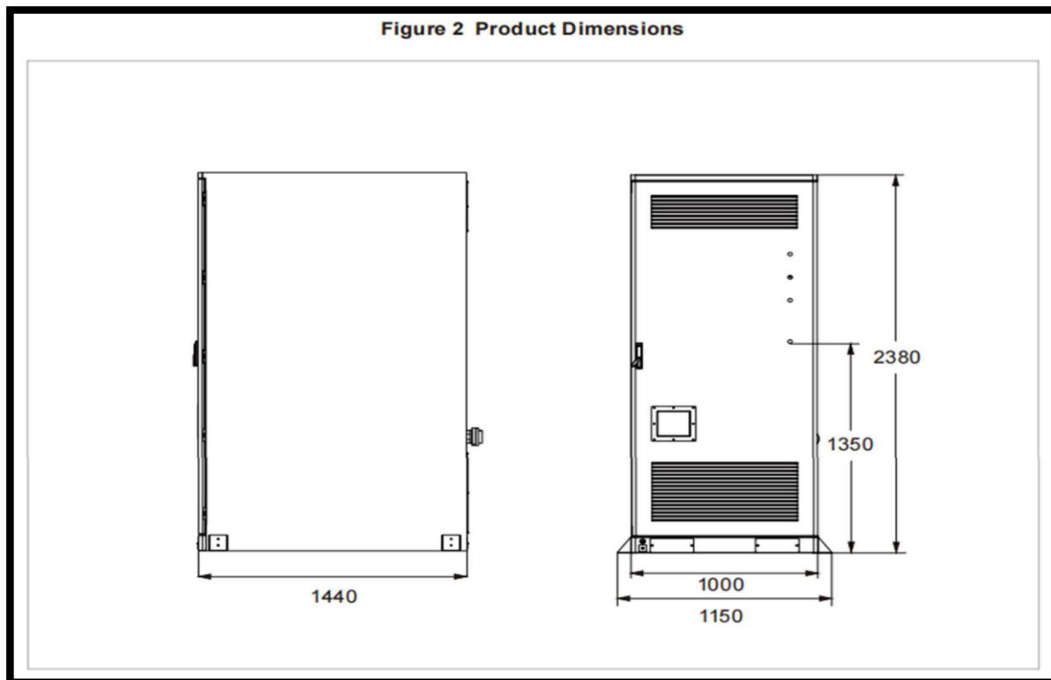



TO:

Figure 2 Product Dimensions

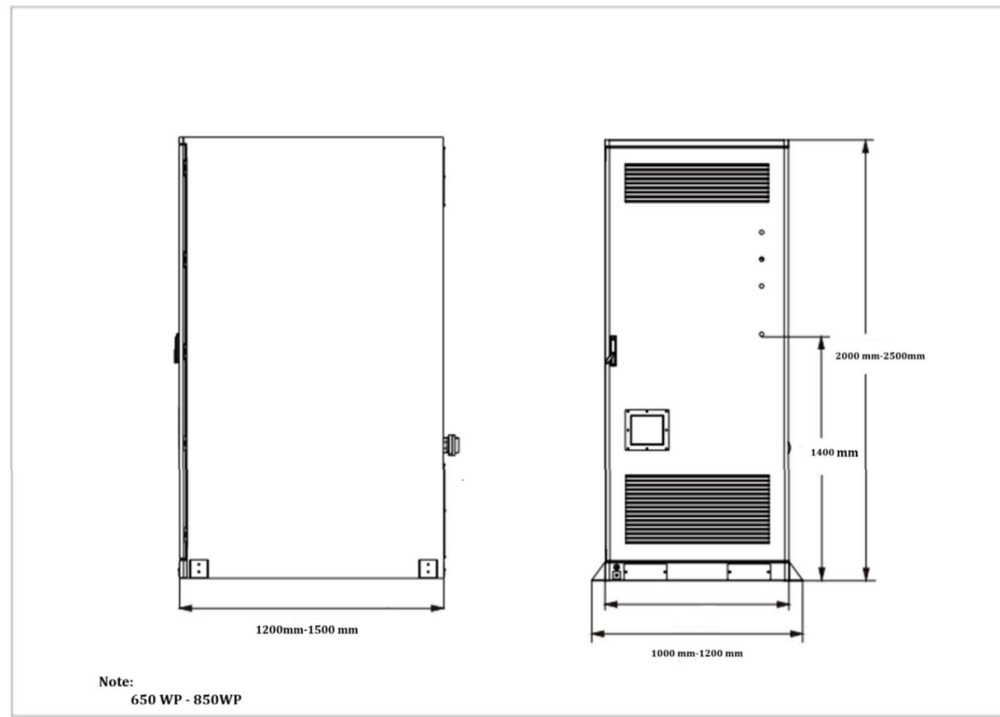



2. ANNEX C

FROM:

Annex C-2

Project Title: Solar Power and Upgrading Electrical System

Location: SLSU-Tomas Oppus Campus, San Isidro, Tomas Oppus, Southern Leyte

Owner: Southern Leyte State University-Tomas Oppus Campus

General Requirements

Item No.	Description	Qty	Unit	Unit Cost	Amount
1	Site Assessment and Survey	1	lot		
2	Mobilization	1	lot		
3	Permits	1	lot		
4	Health and Safety	1	lot		
5	Temporary Facilities	1	lot		
Sub-total				P	

Procurement and Logistics

Item No.	Description	Qty	Unit	Unit Cost	Amount
1	Materials Procurement	1	lot		
2	Logistics Planning	1	lot		
Sub-total				P	

Pre-Installation Phase

Item No.	Description	Qty	Unit	Unit Cost	Amount
1	Re-routing of 3-Phased 150mm Electrical Wire	1	lot		
2	Glass wall Partition with sliding glass door for Internet Server (2.4mx3m)	1	lot		
3	Upgrading of Electrical Lines for Presidential Cottage and Dormitories (If Necessary)	1	lot		
Sub-total				P	

Installation of Solar Panel

Item No.	Description	Qty	Unit	Unit Cost	Amount
1	Roof Preparation	1	lot		
2	Solar Panel Installation				
2.1	620Wp PV Panel	200	module		
2.2	Aluminum PV Railings Roof, 3.0 Meters	148	length		
2.3	L-foot PV Mounting 40mm	220	set		
2.4	Mid-clamp PV Mounting 40mm	220	pcs		





SOUTHERN LEYTE STATE UNIVERSITY

Tomas Oppus Campus

Email: tomas_oppus@southernleytestateu.edu.ph
Website: www.southernleytestateu.edu.ph



Excellence | Service | Leadership and Good Governance | Innovation | Social Responsibility | Integrity | Professionalism | Spirituality

2.5	End-clamp PV Mounting 40mm	280	set		
2.6	6.0 mm2 PV Wire twin	800	meter		
2.7	3"G.I. Pipe with secondary Rack	21	set		
2.8	MC4 PV Connector 30A	50	pair		
2.9	DC Surge Protection device 600v	42	pcs		
2.10	mini DC Breaker 2p 20A	21	pcs		
2.11	18Way Electrical Circuit Breaker box Himel	21	set		
2.12	4 Way electrical Circuit Breaker box Himel	21	set		
2.13	5.5mm2 auto Wire Black	150	mtrs		
2.14	5.5mm2 auto Wire Red	150	mtrs		
2.15	Pipes and other consumable Hardwares	1	lot		
Sub-total P					-

Installation of 1 Unit 261KwH Liquid Cooled BESS

Item No.	Description	Qty	Unit	Unit Cost	Amount
1	261KwH Liquid Cooled BESS	1	lot		
2	Freight and Handling	1	lot		
3	Set-Up and Configuration	1	lot		
Sub-total P					-

Storage Facility

Item No.	Description	Qty	Unit	Unit Cost	Amount
1	4.5x2.5 Closed Storage Facility	1	lot		
Sub-total P					

Post Installation Phase

Item No.	Description	Qty	Unit	Unit Cost	Amount
1	Inspection and Quality Assurance	1	lot		
2	Customer Trainings and Handover	1	lot		
3	Aftersales System Monitoring and Support	1	lot		
Sub-total P					

A. DIRECT COST

1 Material Cost

2 Labor Cost (30-50% of A.1)

SUB-TOTAL

B. INDIRECT COST

Overhead, Contingencies, and Misc. (12%

1 of A.1)

2 VAT, Taxes, Misc. (7% of A.1-4 & B.1)





SOUTHERN LEYTE STATE UNIVERSITY

Tomas Oppus Campus

Email: tomas_oppus@southernleytestateu.edu.ph
Website: www.southernleytestateu.edu.ph



Excellence | Service | Leadership and Good Governance | Innovation | Social Responsibility | Integrity | Professionalism | Spirituality

3 Contractor's Profit (10% of A.1-4)

SUB-TOTAL _____

TOTAL PROJECT COST _____





SOUTHERN LEYTE STATE UNIVERSITY

Tomas Oppus Campus

Email: tomas_oppus@southernleytestateu.edu.ph
Website: www.southernleytestateu.edu.ph



Excellence | Service | Leadership and Good Governance | Innovation | Social Responsibility | Integrity | Professionalism | Spirituality

TO:

Annex C-2

Project Title: **Solar Power and Upgrading Electrical System- 2nd Bidding**

Location: SLSU-Tomas Oppus Campus, San Isidro, Tomas Oppus, Southern Leyte

Owner: Southern Leyte State University-Tomas Oppus Campus

General Requirements

Item No.	Description	Qty	Unit	Unit Cost	Amount
1	Site Assessment and Survey	1	lot		
2	Mobilization	1	lot		
3	Permits	1	lot		
4	Health and Safety	1	lot		
5	Temporary Facilities	1	lot		
Sub-total				P	

Procurement and Logistics

Item No.	Description	Qty	Unit	Unit Cost	Amount
1	Materials Procurement	1	lot		
2	Logistics Planning	1	lot		
Sub-total				P	

Pre-Installation Phase

Item No.	Description	Qty	Unit	Unit Cost	Amount
1	Re-routing of 3-Phased 150mm Electrical Wire	1	lot		
2	Glass wall Partition with sliding glass door for Internet Server (2.4mx3m)	1	lot		
3	Upgrading of Electrical Lines for Presidential Cottage and Dormitories	1	lot		
Sub-total				P	

Installation of Solar Panel

Item No.	Description	Qty	Unit	Unit Cost	Amount
1	Roof Preparation	1	lot		
2	130KWp or higher Roof Solar PV System				
2.1	650Wp or Higher Mono Crystalline Solar PV Panels	200	module		
2.2	Aluminum PV Railings Roof, 3.0 Meters	148	length		
2.3	L-foot PV Mounting 40mm	220	set		
2.4	Mid-clamp PV Mounting 40mm	220	pcs		
2.5	End-clamp PV Mounting 40mm	280	set		
2.6	6.0 mm2 PV Wire twin	800	meter		





SOUTHERN LEYTE STATE UNIVERSITY

Tomas Oppus Campus

Email: tomas_oppus@southernleytestateu.edu.ph
Website: www.southernleytestateu.edu.ph



Excellence | Service | Leadership and Good Governance | Innovation | Social Responsibility | Integrity | Professionalism | Spirituality

2.7	3"G.I. Pipe with secondary Rack	21	set		
2.8	MC4 PV Connector 30A	50	pair		
2.9	DC Surge Protection device 600v	42	pcs		
2.10	mini DC Breaker 2p 20A	21	pcs		
2.11	18Way Electrical Circuit Breaker box Himel	21	set		
2.12	4 Way electrical Circuit Breaker box Himel	21	set		
2.13	5.5mm2 auto Wire Black	150	mtrs		
2.14	5.5mm2 auto Wire Red	150	mtrs		
2.15	Pipes and other consumable Hardwares	1	lot		
Sub-total				P	-

Installation of 1 Unit 261KwH Liquid Cooled BESS

Item No.	Description	Qty	Unit	Unit Cost	Amount
1	261KwH Liquid Cooled BESS	1	lot		
2	Freight and Handling	1	lot		
3	Set-Up and Configuration	1	lot		
4	Net Metering	1	lot		
Sub-total				P	-

Storage Facility

Item No.	Description	Qty	Unit	Unit Cost	Amount
1	4.5x2.5 Closed Storage Facility	1	lot		
Sub-total				P	

Post Installation Phase

Item No.	Description	Qty	Unit	Unit Cost	Amount
1	Inspection and Quality Assurance	1	lot		
2	Customer Trainings and Handover	1	lot		
3	Aftersales System Monitoring and Support	1	lot		
Sub-total				P	

A

DIRECT COST

1 Material Cost

2 Labor Cost (30-50% of A.1)

SUB-TOTAL

B. INDIRECT COST

Overhead, Contingencies, and Misc. (12%

1 of A.1)

2 VAT, Taxes, Misc. (7% of A.1-4 & B.1)





SOUTHERN LEYTE STATE UNIVERSITY

Tomas Oppus Campus

Email: tomas_oppus@southernleytestateu.edu.ph
Website: www.southernleytestateu.edu.ph



Excellence | Service | Leadership and Good Governance | Innovation | Social Responsibility | Integrity | Professionalism | Spirituality

3 Contractor's Profit (10% of A.1-4)

SUB-TOTAL _____

TOTAL PROJECT COST _____

For further inquiries, you may coordinate with the Bids & Awards Committee Secretariat at the following contact numbers: 09273748422/09102826326/09494132405.

Please be guided accordingly.

JUDY O. PAZ

BAC Chairperson

Date: January 22, 2026

